

Valve Installation

Make sure to install the valve according to guidance and directions below:

- The NOWA valve must be installed by a certified plumber according to your local regulation.
- The main water valve must be closed before installing the NOWA valve.
- The NOWA valve should be installed downstream and as near as possible to the main water valve.
- The NOWA valve body does not have flow direction.
- It is recommended to use a thicker teflon threading tape (yellow or orange) for the stainless steel NTP-thread.

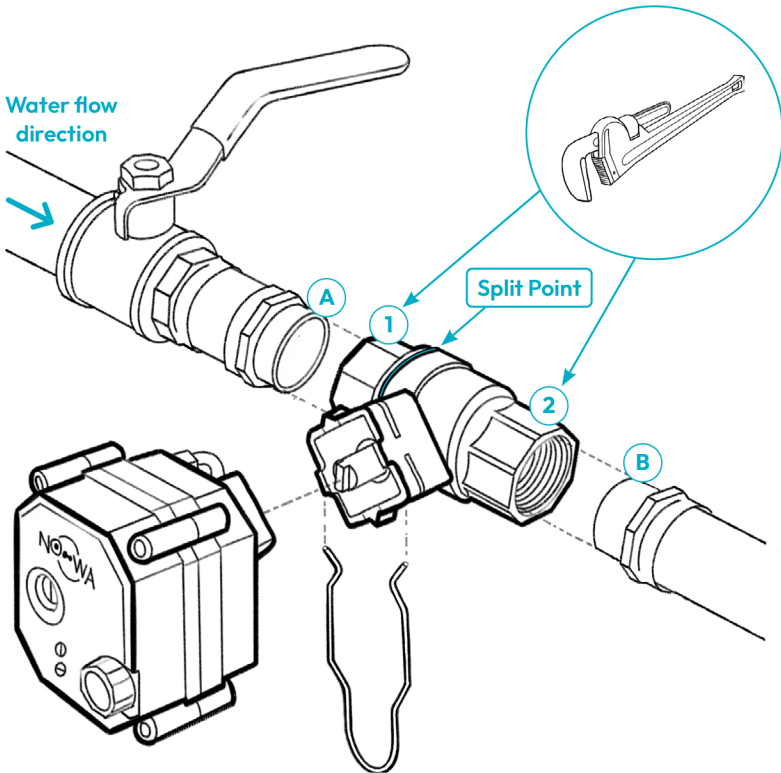

Nipple (A) into part (1)

If you thread inward/outward a nipple (A) into part 1, a pipe wrench needs to be holding part 1.

Nipple (B) into part (2)

If you thread inward/outward a nipple (B) into part 2, a pipe wrench needs to be holding part 2.