

# Connect the Nowa 360 to Internet via Ethernet cable

## Connect the Nowa 360 to the internet via Ethernet cable

1. Power up the Nowa 360 control unit
2. Press the following buttons, one after the other, on the control panel to activate the **"Ethernet mode"** MENU 9 9 9 9 9 ENTER 7
3. The panel will say: **"Ethernet is on"**. If it says **"Wi-Fi is on"** press on 7 again
4. Press on MENU MENU
5. Connect the Ethernet cable to your router and to the Nowa 360 panel like shown on the picture
6. Once connected you will be able to use the mobile app to finalize the configuration.

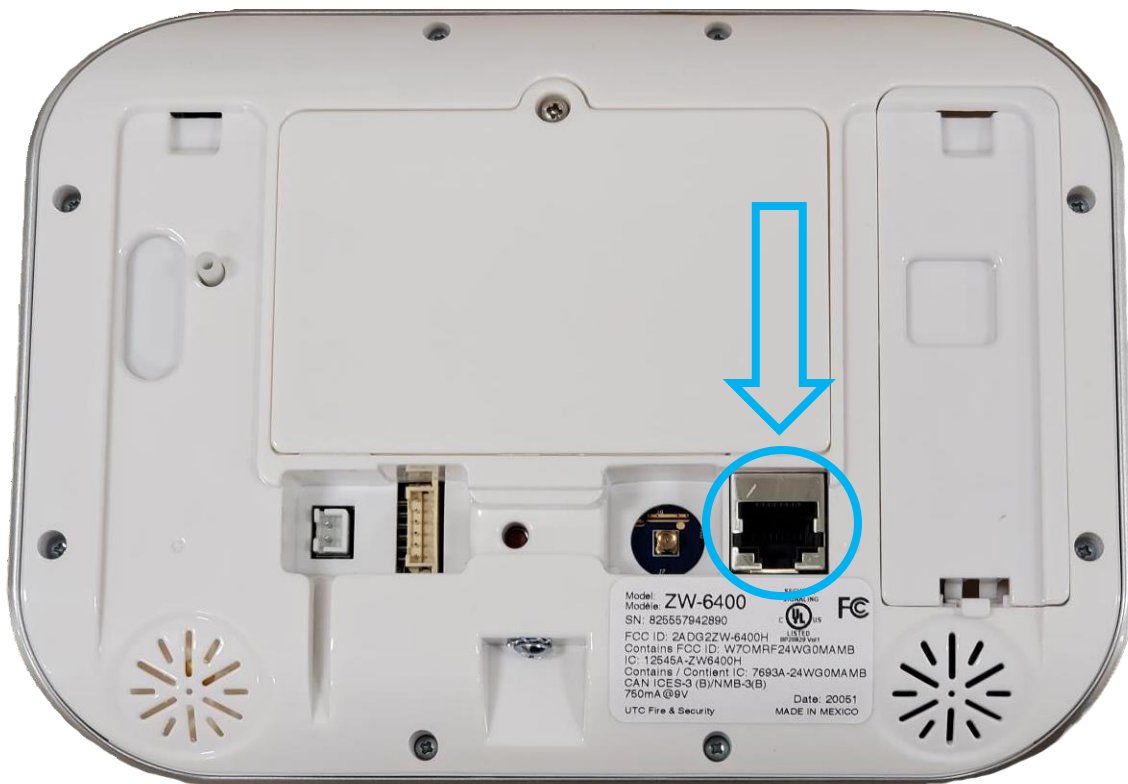

[www.nowasupport.com](http://www.nowasupport.com)

[nowa360.com](http://nowa360.com)